

**TRUST  
THE  
ORIGINAL**

# XLR Connectors



**NEUTRIK®**

Content	Page
<b>Cable Connectors:</b>	
XX Series .....	4
XLR TOP® Series .....	4
RX Series .....	5
XX-HE Series .....	5
XX-14 Series .....	6
XX Crimp Series .....	6
crystalCON® .....	7
EMC-XLR Series .....	7
convertCON® .....	8
X Series .....	8
X-HD Series .....	9
XCC Series .....	9
FXS Series .....	10
FX-SPEC Series .....	10
8 + 2 pole XLR Type Data Power Connector .....	11
Technical Data .....	12
Ordering Information .....	14
Accessories .....	16
<b>Receptacles:</b>	
A Series .....	18
AA Series .....	18
B Series .....	19
A/B Series - Switch .....	19
XLR TOP® Series .....	20
D Series .....	20
DL Series .....	21
DLX Series .....	21
DLX Crimp Series .....	22
EMC Series .....	22
MPR-HD Series .....	23
P Series .....	23
Combo I Series .....	24
Combo A Series .....	25
Technical Data .....	26
Ordering Information .....	28
Accessories .....	31
<b>General Information:</b>	
Definitions, Abbreviations & Useful Information .....	33
Neutrik Part Number Guide .....	34
Neutrik Product Line .....	35

XLR Connectors



Introduction

Neutrik XLR connectors are the most well-known series of products manufactured by Neutrik, and have provided the professional audio industry a simple, yet striking, concept in connector features. We introduced our first XLR product 40 years ago. Today it is the accepted standard worldwide.

XLR connectors are part of almost every aspect of professional audio; as a microphone connector, in lighting systems, and found in almost any piece of sound equipment in the entertainment industry. The outstanding success of our XLR products is Neutrik's blend of innovation with the highest quality performance.



Ergonomic latch design



White painted housing



Rubber sealing protection



IP65 in mated condition



Right angle male connector



High temperature resistant insulator



Velour chromium housing

XX Series

XLR TOP Series

RX Series

XX-HE Series



NC3FXX



NC6MXX-B



NC3FX-TOP



NC3MX-TOP



NC3FRX-BAG

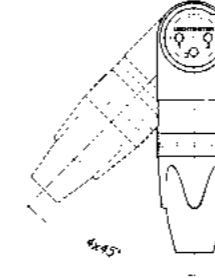

Outlet position



NC3FXX-HE



NC3MXX-HE

- The next generation of the worldwide accepted standard
- Unique cage type female contact – increases conductivity
- Female contact with “solder stop” for ease of soldering
- Male connector without locking “window” – more robust housing, increases durability
- Improved chuck type strain relief - increases retention force and makes assembly easier and faster
- New ground contact – excellent contact integrity between chassis and cable connector
- Customized branding using translucent ring
- Sleek and ergonomic design – valuable and handy
- Unique hologram – guarantees genuineness and protects against counterfeits
- Internal thread on shell is well protected against any damage

- Heavy-duty sealed XLR connector range
- 3 and 5 pin cable connector
- IP65 rating and certified outdoor protection to UL 50E (in combination with a TOP range counterpart)
- Uses high impact UV resistant materials per UL
- Gold plated contacts
- Maintains sealing when in use and when disconnected

- Right angle version of the XX Series – only 20 mm wide
- Extra slim right-angle connector
- Neutrik chuck type strain relief
- 5 selectable cable outlet positions on female & 7 position on male connectors

- Exclusive "High End" version of standard XX Series
- Premium velour chromium plating provides soft satin finish
- Extra high temperature resistant insulator material rated to 280 °C (536 °F)
- Machined female contacts standard
- Insert is dark grey to distinguish it from standard XX-Series insulators
- Flammability UL 94V-0

NC\*FXX

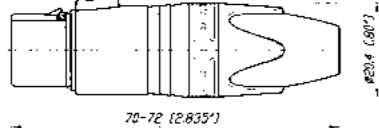

NC\*MXX

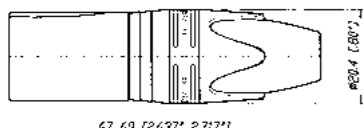

\*: 3 - 7 contacts

NC\*FX-TOP

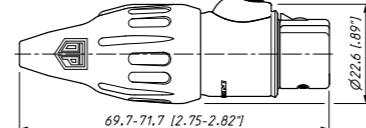

NC\*MX-TOP

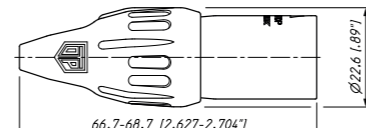

\*: 3 & 5 contacts

NC\*FRX

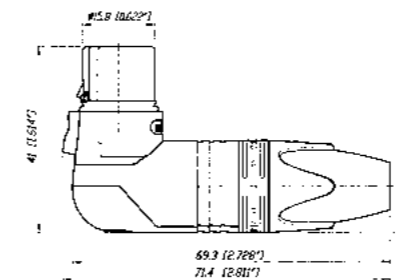

NC\*MRX

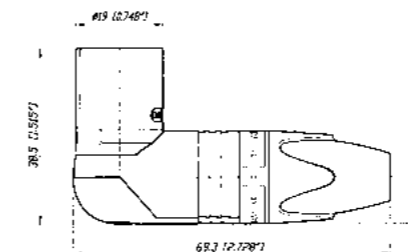

\*: 3 - 7 contacts

NC3FXX-HE

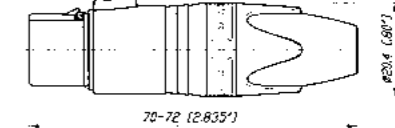

NC3MXX-HE

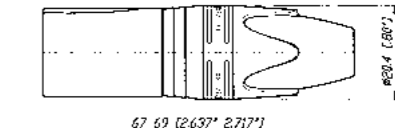

\*: 3 - 7 contacts





Large cable outlet



Ergonomic latch design



Neutrik hologram



CRYSTALLIZED™ – Swarovski Elements



Circumferential ground shield contact



Neutrik hologram

**XX-14 Series**

**XX Crimp Series**

**crystalCON**

**EMC-XLR Series**



NC3FXX-14



NC3MXX-14-B



NC3FXX-HA-BAG



NC3MXX-HA



NC3FXX-B-CRYSTAL



NC3MXX-B-CRYSTAL



NC3FXX-EMC



NC3MXX-EMC

- Special version of the XX Series XLR cable connector for large cable diameters
- Incorporates all the features of the XX product series
- Rear boot features large opening for use with cable O.D. 8.0 – 10.0 mm
- Bulk packed; must be ordered in multiples of 100

- 3 pin XX Series with crimp contacts
- Accommodates wire size AWG 24 - 22 or 0.22 – 0.34 mm<sup>2</sup>
- Absolute leadfree and solderless connection:
  - RoHs compliant
  - health and eco-friendly
- Fast and easy assembly
- Gas-tight connection offers constant contact resistance
- Ideal solution for field and on-site termination

- 3 pole XLR XX-Series embellished with CRYSTALLIZED™ – Swarovski Elements
- Exclusively with gold plated contacts, and black chrome housing
- Fancy, noble, valuable, attractive package – an eye-catcher
- With all benefits of the XLR XX-Series

- 3 pole male / female XLR cable connector with integrated capacitive shield to shell connection to avoid RF-interference and LF-noise
- 360° shield contact on female connector ensures best possible shielding and chassis contact
- Avoid ground loops as there is no LF-shield connection to ground
- Patented

NC3FXX-14

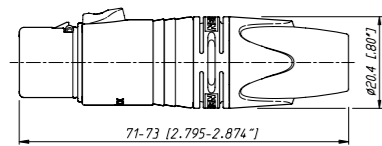

NC3MXX-14

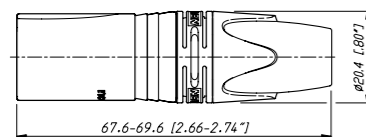

NC3FXX-HA

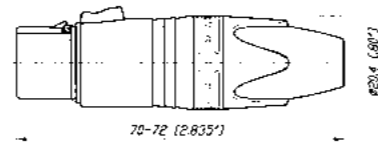

NC3MXX-HA

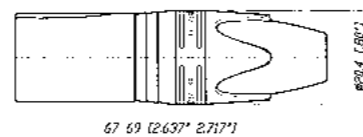

NC3FXX-B-CRYSTAL

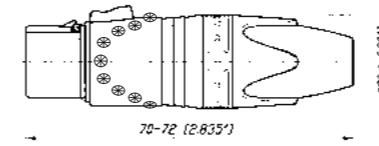

NC3MXX-B-CRYSTAL

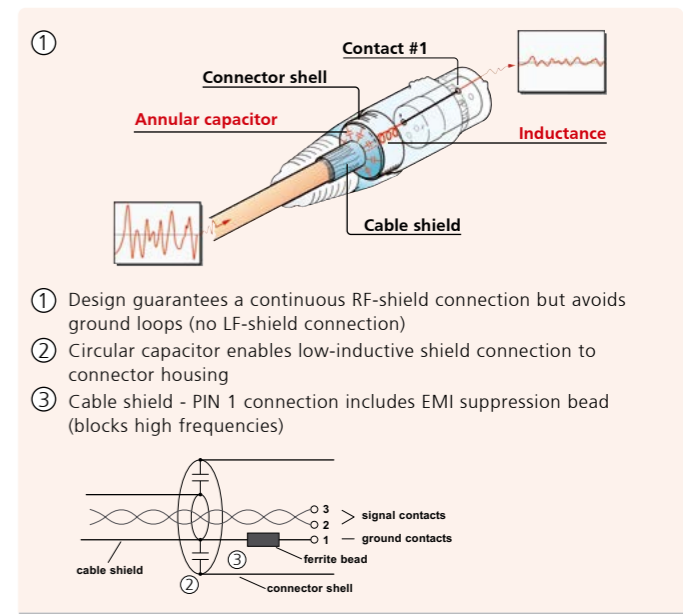
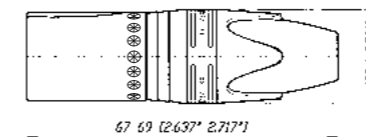



convertCON position male – female

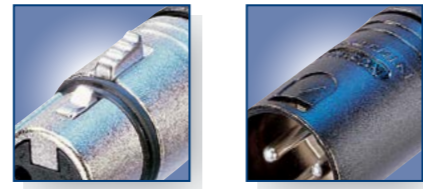

Female locking Male metal locking window



Rubber sealing protection Metal bushing



Coding ring

**convertCON**

**X Series**

**X-HD Series**

**XCC Series**



NC3FM-C-B NC3FM-C



NC3FX NC3MX + BSX-5



NC5FX-HD NC4MX-HD



NC3FXCC

- World's first unisex XLR cable connector
- 3 pole male and female cable connector in one housing
- Easy selectable gender – converted by sliding housing back and forth
- Substitutes adapters, ideal as an emergency kit
- Exclusively with gold plated contacts
- With all benefits of the XLR XX-Series

- The worldwide XLR connector standard
- Available in 3 – 7 pin configuration including 6 pin Switchcraft® configuration
- Assembly is quick and easy – no screws or special tools required
- Unique Neutrik chuck type strain relief
- Female shell features rubber ring for secure mating to male XLR or microphone
- Sleek profile and compact design
- Rugged diecast shell
- UL recognized components

- "Heavy duty" cable connectors for outdoor use
- All metal design, male stainless steel
- NC\*FX-HD mates with NC\*MPR-HD chassis connector and NC\*MX-HD
- Dust and water resistant according IP 65 in mated condition
- Available in 3 – 5 pin configuration
- Metal bushing including O-ring

- Coaxial ground spring and hex crimp ferrule at cable entrance allow continuous (360°) ground connection to shell which is essential when transmitting low level audio signals
- Includes Zebra coding ring to indicate digital AES signals
- Ground contact uses 6.5 mm (.255") size "E" hex crimp (IEC 60803). Use part # HX-R-BNC with DIE-R-BNC-PT

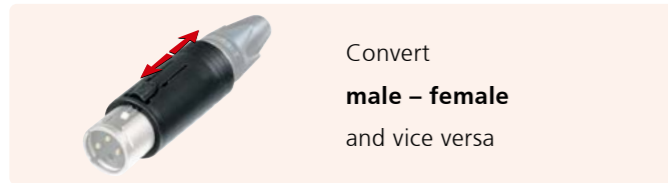

Convert male – female and vice versa

NC3FM-C: Position female

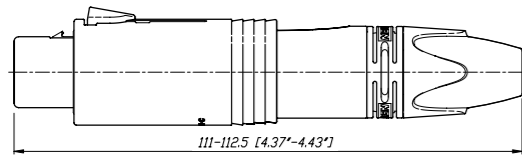

NC3FM-C: Position male

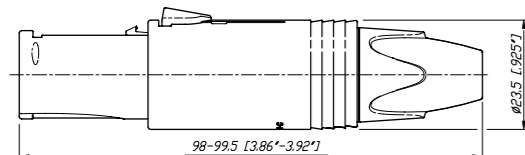

NC\*FX

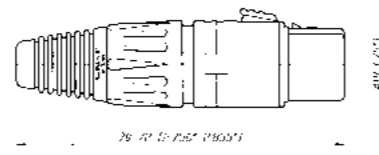

NC\*MX

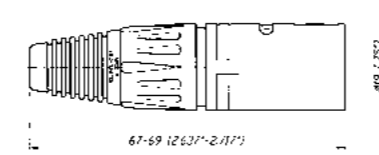

\*: 3 - 7 contacts

NC\*FX-HD

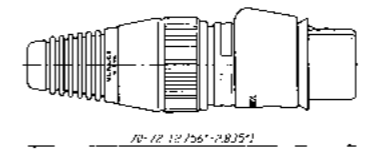

NC\*MX-HD

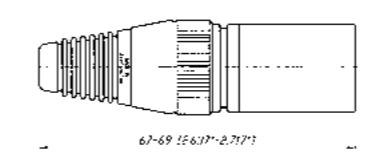

\*: 3 - 5 contacts

NC3FXCC

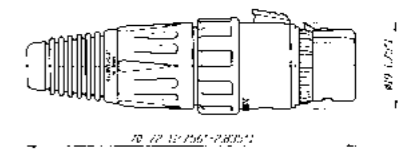

NC3MXCC

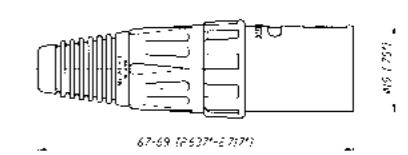



Switch activating ring



Locking ring



NEW 8 + 2 pole cable connector



Ergonomic latch design



New 8 + 2 pole D-size receptacle



Solder termination

FXS Series

FX-SPEC Series



NC3FXS

NC3FXS-B



NC3FX-SPEC

- Available exclusively in a 3 pin female configuration
- Features a noiseless ON/OFF switch which shorts pins 2 and 3 together muting the signal voltage between conductors
- For use with a microphone that does not have its own On / Off switch
- Rugged zinc diecast shell, long lasting and durable
- Chuck type strain relief system for secure clamping of cables
- Boot with rubber gland gives high protection against bending stresses

- Available in a 3 pin female standard configuration with gold plated contacts
- Features a locking ring which is secured with a M 2.5 screw and 1.27 mm allen wrench
- Offers the highest security protection for your microphones
- Protects against accidental disconnects and theft
- Black chrome housing and locking ring
- Eliminates movements and noises

NC3FXS

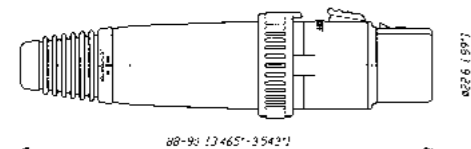

NC3FX-SPEC

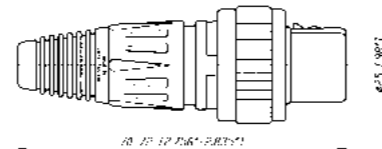

XLR Type Data Power Connectors - 8 + 2 pole



NC10FXX-14-B



NC10FRX-14-B



NC10MD-LX-B

- Suitable for data offering CAT 5e performance and power up to 16 A and 50 V - exceeds PoE+ capabilities
- Superior ruggedness compared to RJ45 type connectors
- All metal housing offers best overall RF protection and electromagnetic shielding
- D-size housing provides installation compatibility with industry standard D mounting dimensions
- Receptacle with duplex ground contact for excellent signal integrity

8 + 2 pole Contact Arrangement:

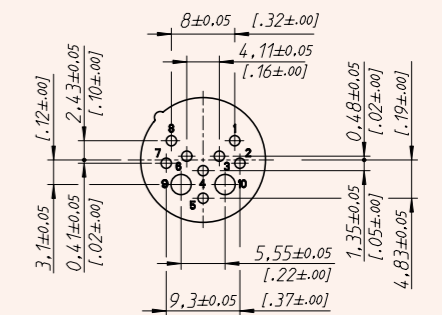

NC10FXX-14-B

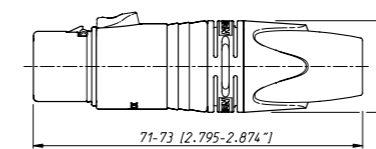

NC10MXX-14-B

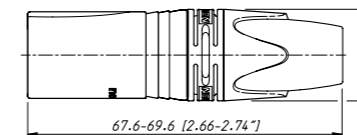

NC10FD-LX-B

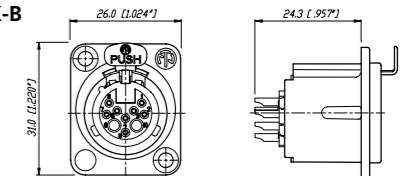

NC10MD-LX-B

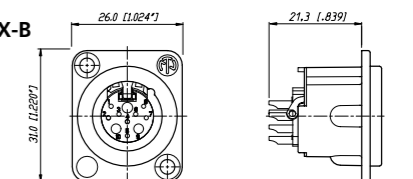

Specification	XX & XX-14 & crystalCON Series	XLR TOP Series	RX Series	XX-HE Series	XX Crimp Series	EMC Series	convertCON Series
---------------	--------------------------------	----------------	-----------	--------------	-----------------	------------	-------------------

Electrical							
Number of contacts	3 - 7 <sup>1)</sup>	3 - 5	3 - 7	3	3	3	3
Contact resistance	≤ 3 mΩ	•	•	•	•	•	•
Insulation resistance - initial:	> 10 GΩ	•	•	•	•	•	•
- after damp heat test:	> 1 GΩ	•	•	•	•	•	•
Dielectric strength	1.5 kV dc	•	•	•	•	•	•
Cable shield-shell connection	choosable	•	•	•	•	-	•
	determined	-	-	-	-	capacitive	-
Shielding effectiveness	> 55 dB @ 1.3 GHz	-	-	-	-	•	-
Lossy ferrite bead on PIN 1		-	-	-	-	•	-
Rated current per contact @ 35°C							
3 pole:	16 A	•	•	•	•	1 A	5 A
4 pole:	10 A	•	-	•	-	-	-
5, 6 pole:	7.5 A	•	•	•	-	-	-
7 pole:	5 A	•	-	•	-	-	-
Capacitance between contacts							
3 pole:	≤ 4 pF	•	•	•	•	•	•
4, 5, 6 pole:	≤ 7 pF	•	•	•	-	-	-
7 pole:	≤ 9 pF	•	-	•	-	-	-
Rated Voltage	< 50 V ac	•	•	•	•	•	•

Mechanical							
Lifetime	> 1'000 cycles	•	•	•	•	•	•
Insertion / withdrawal force	≤ 20 N	•	•	•	•	•	≤ 50 N
Cable O.D. range	3.5 - 8.0 mm	• <sup>2)</sup>	5.0 - 8.0 mm	•	•	•	•
Max. wire size	3 pole: 2.5 mm <sup>2</sup> / AWG 14	•	AWG 16	•	•	-	AWG 20
	4 pole: 1.5 mm <sup>2</sup> / AWG 16	•	-	•	-	-	-
	5, 6, 7 pole: 1.0 mm <sup>2</sup> / AWG 18	•	AWG 16	•	-	-	-
Crimp XX:	0.22 - 0.34 mm <sup>2</sup> / AWG 24 - 22	-	-	-	-	•	-

Material							
Shell	Zinc diecast (ZnAl4Cu1)	•	• (F)	•	•	•	•
	Stainless steel	-	• (M)	-	-	-	-
Shell plating	gal Ni or black Cr	•	•	•	velour Cr	•	•
Insert	Polyamide PA 6.6	•	•	•	PPS 40% GR	•	•
Contacts - female 3 pole:	Bronze (CuSn8)	•	•	•	Brass	•	•
- female 4 - 7 pole & male:	Brass (CuZn39Pb3)	•	•	•	-	•	•
Contact surface	Silver gal 2 μm Ag	•	-	•	-	-	•
or Gold	gal 0.2 μm Au hard alloy over 2 μm Ni	•	•	•	-	•	•
Latch lock	St3K32 (latch) / Ck 67 (spring)	-	•	-	-	-	-
	Zinc diecast (ZnAl4Cu1) / CK67 (Spring)	•	-	•	•	•	•
Strain-relief clamp	POM	•	•	•	•	•	•
Bushing	PA / PU	•	UV-resistant rubber	•	•	•	•
Circumferential ground spring	Bronze (CuSn6), Ni plated	-	-	-	-	-	-
Crimp ferrule	Brass (CuZn39Pb3), Ni plated	-	-	-	-	-	-
Coding ring	Polyamide PA 6 15% GR	-	-	-	-	-	-
Sealing jacket	EPDM	-	-	-	-	-	-
Securing ring	Brass (CuZn39Pb3)	-	-	-	-	-	-

Environmental							
Operating temperature	-30 °C to +80 °C	•	•	•	•	•	•
Flammability	UL 94 V-0 (●) / UL 94 HB (○)	•	•	•	•	•	○
Protection class	IP 40	•	IP65 <sup>3)</sup>	•	•	•	•
Solderability complies with	IEC 68-2-20	•	•	•	•	•	•
Manufacturing Standard	IEC 61076-2-103	•	•	•	•	•	•

<sup>1)</sup>: XX-14, CRYSTAL: 3 pole    <sup>2)</sup>: XX-14: Cable O.D. 8.0 - 10.0 mm    <sup>3)</sup>: UL50E (mated)

Specification	X Series	XCC Series	X-HD Series	FXS Series	FX-SPEC Series	Data Power XLR
---------------	----------	------------	-------------	------------	----------------	----------------

Electrical						
Number of contacts	3 - 7	3	3 - 5	3	3	8 + 2
Contact resistance	≤ 3 mΩ	•	•	•	•	•
Insulation resistance - initial:	> 10 GΩ	•	•	•	•	•
- after damp heat test:	> 1 GΩ	•	•	•	•	0.1 GΩ
Dielectric strength	1.5 kV dc	•	•	•	•	1 kV dc
Cable shield-shell connection	choosable	•	-	•	-	•
	determined	-	crimp	-	-	-
Shielding effectiveness	> 55 dB @ 1.3 GHz	-	•	-	-	-
Lossy ferrite bead on PIN 1		-	-	-	-	-
Rated current per contact @ 35°C						16 A (power pins)
3 pole:	16 A	•	•	•	•	-
4 pole:	10 A	•	-	•	-	-
5, 6 pole:	7.5 A	•	-	•	-	-
7 pole:	5 A	•	-	-	-	3 A (data pins)
Capacitance between contacts						
3 pole:	≤ 4 pF	•	•	•	•	-
4, 5, 6 pole:	≤ 7 pF	•	-	•	-	-
7 pole:	≤ 9 pF	•	-	-	-	-
Rated Voltage	< 50 V ac	•	•	•	•	-
Transmission Performance	CAT 5e	-	-	-	-	•

Mechanical						
Lifetime > 1'000 cycles		•	•	•	•	•
Insertion / withdrawal force	≤ 20 N	•	•	•	•	•
Cable O.D. range	3.5 - 8.0 mm	•	5.4 - 6.2 mm	•	3.5 - 7.0 mm	•
Max. wire size	3 pole: 2.5 mm <sup>2</sup> / AWG 14	•	•	•	•	• (2 power)
	4 pole: 1.5 mm <sup>2</sup> / AWG 16	•	-	•	-	•
	5, 6, 7 pole: 1.0 mm <sup>2</sup> / AWG 18	•	-	•	-	• (8 data)
Crimp tool:	6.5 mm Hex die (size "E" acc. to IEC 60803)	-	•	-	-	-
Crimp XX:	0.22 - 0.34 mm <sup>2</sup> / AWG 24 - 22	-	-	-	-	-

Material						
Shell	Zinc diecast (ZnAl4Cu1)	•	•	female	•	•
	Stainless steel	-	-	male	-	-
Shell plating	gal Ni or black Cr	-	•	female	•	black Cr
Insert	Polyamide PA 6.6	•	•	•	•	•
Contacts - female 3 pole:	Bronze (CuSn8)	•	•	•	•	-
- female 4 - 7 pole & male:	Brass (CuZn39Pb3)	•	•	•	-	•
Contact surface	Silver gal 2 μm Ag	•	-	-	•	-
or Gold	gal 0.2 μm Au hard alloy over 2 μm Ni	-	•	•	-	•
Latch lock	St3K32 (latch) / Ck 67 (spring)	•	•	•	•	-
	Zinc diecast (ZnAl4Cu1)	-	-	-	-	•
Strain-relief clamp	POM	•	•	•	•	•
Bushing	PA / PU	•	•	SS/PU	PU	•
Circumferential ground spring	Bronze (CuSn6), Ni plated	-	•	-	-	-
Crimp ferrule	Brass (CuZn39Pb3), Ni plated	-	•	-	-	-
Coding ring	Polyamide PA 6 15% GR	-	•	-	-	-
Sealing jacket	EPDM	-	-	•	-	-
Securing ring	Brass (CuZn39Pb3)	-	-	-	-	•

Environmental						
Operating temperature	-30 °C to +80 °C	•	•	•	•	•
Flammability	UL 94 V-0	•	•	•	•	•
Protection class	IP 40	•	•	IP 65	•	•
Solderability complies with	IEC 68-2-20	•	•	•	•	•
Manufacturing Standard	IEC 61076-2-103	•	•	•	•	•



Ordering Information for Cable Connectors

Female	Male	Shell	Contact - plating	3 pole	4 pole	5 pole	6 pole	7 pole
<b>XX Series</b>								
NC*FXX	NC*MXX	Nickel	Silver	●	●	●	●	●
NC*FXX-B	NC*MXX-B	Black Cr	Gold	●	●	●	●	●
NC*FXX-BAG	NC*MXX-BAG	Black Cr	Silver	●	●	●	●	●
NC3FXX-WT	NC3MXX-WT	White painted	Silver	●	-	-	-	-
NC3FXX-**-D <sup>1</sup>	NC3MXX-**-D <sup>1</sup>	Nickel / Black Cr	Silver / Gold	●	-	-	-	-
NC6FSXX <sup>2</sup>	NC6MSXX <sup>2</sup>	Nickel	Silver	-	-	-	●	-
NC6FSXX-B <sup>2</sup>	NC6MSXX-B <sup>2</sup>	Black Cr	Gold	-	-	-	●	-
NC6FSXX-BAG <sup>2</sup>	NC6MSXX-BAG <sup>2</sup>	Black Cr	Silver	-	-	-	●	-
<b>XLR TOP Series</b>								
NC*FX-TOP	NC*MX-TOP	Nickel / Black Cr	Gold	●	-	●	-	-
<b>RX Series</b>								
NC*FRX	NC*MRX	Nickel	Silver	●	●	●	●	●
NC*FRX-B	NC*MRX-B	Black Cr	Gold	●	●	●	●	●
NC*FRX-BAG	NC*MRX-BAG	Black Cr	Silver	●	●	●	●	●
<b>XX-HE Series</b>								
NC3FXX-HE	NC3MXX-HE	Velour Chromium	Gold	●	-	-	-	-
<b>XX-14 Series</b>								
NC3FXX-14-D	NC3MXX-14-D	Nickel	Silver	●	-	-	-	-
NC3FXX-14-B-D	NC3MXX-14-B-D	Black Cr	Gold	●	-	-	-	-
NC3FXX-14-BAG-D	NC3MXX-14-BAG-D	Black Cr	Silver	●	-	-	-	-
<b>XX Crimp Series</b>								
NC3FXX-HA	NC3MXX-HA	Nickel	Silver	●	-	-	-	-
NC3FXX-HA-BAG	NC3MXX-HA-BAG	Black Cr	Silver	●	-	-	-	-
<b>crystalCON</b>								
NC3FXX-B-CRYSTAL	NC3MXX-B-CRYSTAL	Black Cr	Gold	●	-	-	-	-
<b>XX-EMC Series</b>								
NC3FXX-EMC	NC3MXX-EMC	Nickel	Gold	●	-	-	-	-
NC3FXX-EMC-B	-	Black Cr	Gold	●	-	-	-	-
<b>convertCON Series</b>								
	NC3FM-C	Nickel	Gold	●	-	-	-	-
	NC3FM-C-B	Black Cr	Gold	●	-	-	-	-

Ordering Information for Cable Connectors

Female	Male	Shell	Contact - plating	3 pole	4 pole	5 pole	6 pole	7 pole
<b>X Series</b>								
NC*FX	NC*MX	Nickel	Silver	●	●	●	●	●
NC*FX-B	NC*MX-B	Black Cr	Gold	●	●	●	●	●
NC*FX-BAG	NC*MX-BAG	Black Cr	Silver	●	●	●	●	●
NC3FX-**-D <sup>1</sup>	NC3MX-**-D <sup>1</sup>	Nickel / Black Cr	Silver / Gold	●	-	-	-	-
NC6FSX <sup>2</sup>	NC6MSX <sup>2</sup>	Nickel	Silver	-	-	-	●	-
NC6FSX-B <sup>2</sup>	NC6MSX-B <sup>2</sup>	Black Cr	Gold	-	-	-	●	-
NC6FSX-BAG <sup>2</sup>	NC6MSX-BAG <sup>2</sup>	Black Cr	Silver	-	-	-	●	-
<b>X-HD Series</b>								
NC*FX-HD	NC*MX-HD	Nickel	Gold	●	●	●	-	-
NC3FX-HD-B	NC3MX-HD-B	Metal Black	Gold	●	-	-	-	-
<b>XCC Series</b>								
NC3FXCC	NC3MXCC	Nickel	Gold	●	-	-	-	-
<b>FXS Series</b>								
NC3FXS	-	Nickel	Gold	●	-	-	-	-
NC3FXS-B	-	Black Cr	Gold	●	-	-	-	-
<b>FX-SPEC. Series</b>								
NC3FX-SPEC.	-	Black Cr	Gold	●	-	-	-	-

Ordering Information for 8 + 2 pole Data Power Connectors

Female	Male	Shell	Contact - plating	8 + 2 pole
<b>Cable Connector</b>				
NC10FXX-14-B	NC10MXX-14-B	Black Cr	Gold	●
NC10FRX-14-B	NC10MRX-14-B	Black Cr	Gold	●
<b>Receptacle</b>				
NC10FD-LX-B	NC10MD-LX-B	Black Cr	Gold	●

\* : Number of Contacts  
 \*\*: Nickel or Black  
 -D<sup>1</sup>: Bulk packed, to be ordered in multiples of 100 pcs.  
<sup>2</sup>: Switchcraft Equivalent





Colour Coded Accessories

Part No.	Description	Black	Brown	Red	Orange	Yellow	Green	Blue	Violet	Grey	White
		0	1	2	3	4	5	6	7	8	9
BSX-*	Colored bushing for X Series										
BXX-*	Colored bushing for XX Series										
XCR-*	Colored coding ring for X Series										
XXR-*	Colored coding ring for XX Series										

Accessories

BXX-CR	Bushing with translucent coding ring		
BXX-14	Large bushing set (cable O.D. 8.5 mm)		
XXCR	Translucent coding ring for XX Series Label Dimensions: 57.9 mm x 6.35 mm – 2.25" W x 0.25" H)		

Assembly Tools

HTXP	Hand tool to tighten the XX and PX-bushing		HTXP
HTXX-14	Hand tool to tighten the XX-14 and 8 + 2 pole bushing		
BTXX	Speed boot assembly tool to press the XX boot onto shell		BTXX-14
HX-R-BNC	Crimp tool for XCC Series		HX-R-BNC
DIE-R-BNC-PT	Crimp die for XCC Series (6.5 mm HEX)		DIE-R-BNC-PT
DIE-R-HA-1	Crimp die for XX-HA Series		

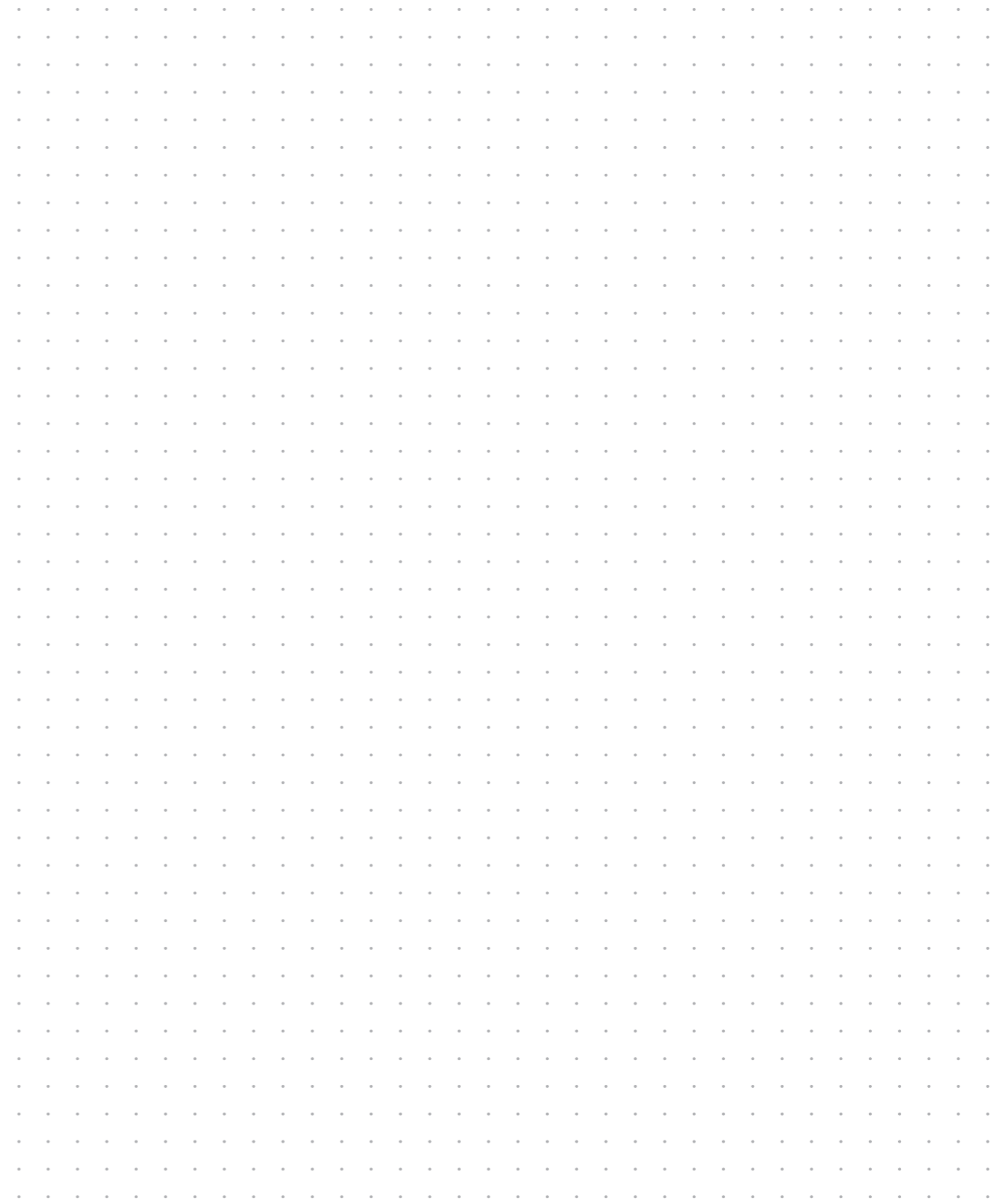

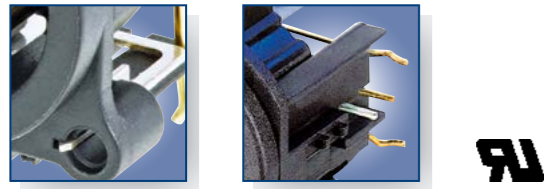

Smallest receptacle  
Lateral right PCB mount



Locking release tab  
Ground contact  
Ergonomic asymmetric locking release tab



Front panel grounding  
Ergonomic asymmetric locking release tab



Incorporated switch

A Series



NC3FAH  
NC3MAV

AA Series



NC3FAAV2  
NC3MAAH-1

B Series



NC3FBV1  
NC4MBV

A/B Series - Switch



NC3FBV2-SW  
NC3MBV-SW

- Smallest XLR receptacles, highest packing density
- Plastic housing
- Various grounding options
- "Tulip" type female contact design with high contact pressure
- Selective gold plated contact and PCB termination area for best conductivity and solderability
- Plastic housing flammability UL 94V-0 for 3 pole version only

- Front panel cutout and PCB layout 100% compatible to the A Series
- Most cost-effective series
- "Tulip" type female contact design with high contact pressure
- Selective gold plated contact and PCB termination area for best conductivity and solderability
- Plastic housing flammability UL 94 HB

- The B Series XLR receptable offers the same features as our A Series product line with the added feature of a metal ring
- Metal ring on shell (nickel or black) offers complete EMC and RF protection
- Female versions available latchless
- Rear mount only
- "Tulip" type female contact
- Plastic housing flammability UL 94V-0 for 3 pole version only

- A and B Series connector with additional switch
- Normally open, normally closed (NO – NC) contact
- Switch activated by mating XLR cable connector

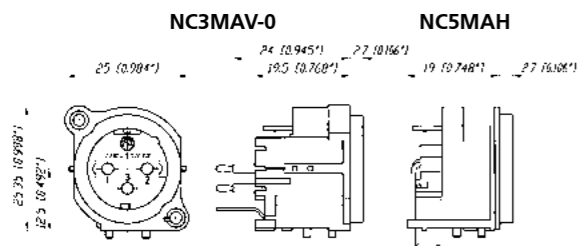
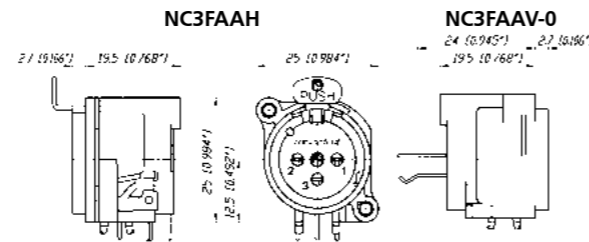
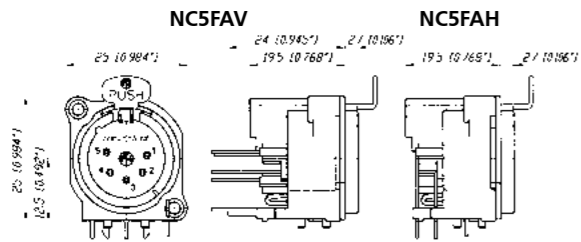

Grounding Options (A / AA / B Series):

**Female:**  
 1: Pin 1 & Panel & Shell connected, no separate ground contact  
 2: Separate ground contact connected to shell & panel, separate Pin 1 w/o number: No ground / Shell contact (except 4 / 5 pole)

**Male:**  
 0: Separate ground contact, connected to shell, separate Pin 1  
 1: Pin 1 & Panel & Shell connected, no separate ground contact w/o number: Separate ground contact connected to shell & panel, separate Pin 1

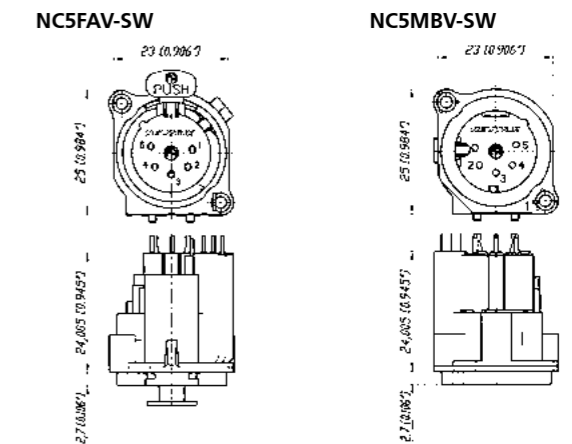
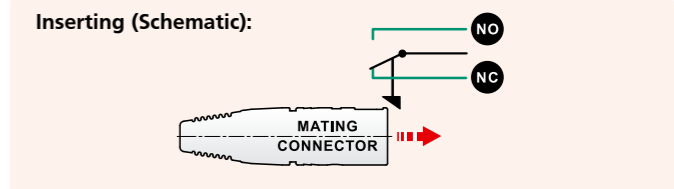
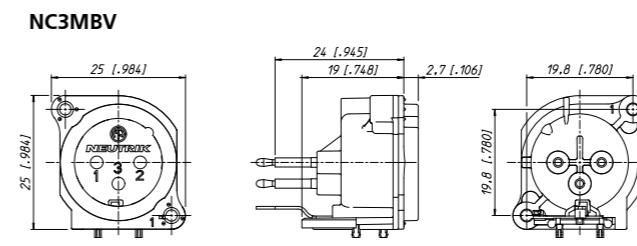
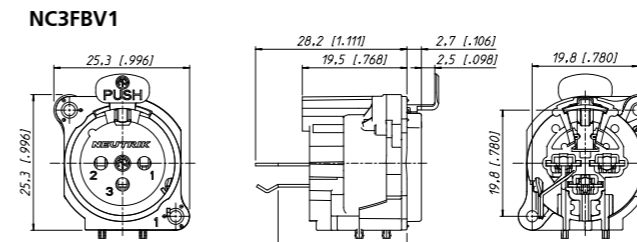



Locking release tab



Removable insert



Locking release tab

Horizontal PCB mount



Ground shielding

White painted housing

**XLR TOP Series**

**D Series**

**DL Series**

**DLX Series**



NC3FDX-TOP

NC3MDX-TOP



NC3FDM3-H-B

NC3MD-V

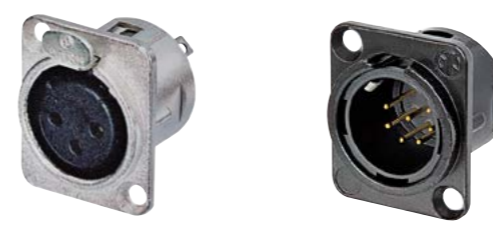

NC3FD-L-1

NC7MD-L-B-1



NC3FD-LX-HE

NC5MD-LX

- Heavy-duty sealed XLR connector range
- 3 and 5 pin chassis connector
- Outdoor protection acc. IP65 and UL 50E
- Uses high impact UV resistant materials per UL
- Gold plated contacts
- Maintain sealing when in use and when disconnected
- Optional waterproof and UV resistant protection cap

- "D" shape metal shell
- Optimal RF protection using 3 shield contacts
- Horizontal and vertical PCB mount with separate ground contact
- Mounting holes with M3 threads available
- 2 piece connector, insert is removable from shell
- Front locked / unlocked insert

- Unified "D" shape metal shell
- Solder cups on 3 – 7 pole version
- Additional PCB mount on 4 and 5 pole
- Front and rear mountable

- Next generation of the popular DL Series with greater functionality
- All metal housing offers best overall RF protection and electromagnetic shielding
- Duplex ground contact for excellent contact integrity between chassis and cable connector
- Unique cage type female contact on 3 pole version increases conductivity and reduces wear on the mated male contact
- Female contact incorporates a solder barrier to prevent solder running into the contact mating area
- Larger solder contacts for easier termination
- Optional connection to easily join pin1 to chassis ground
- D-style housing provides installation compatibility with

**NC\*FDX-TOP**

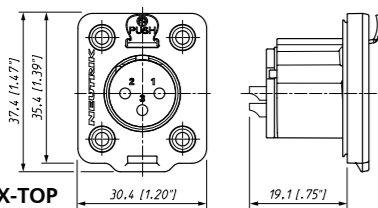

**NC\*MDX-TOP**

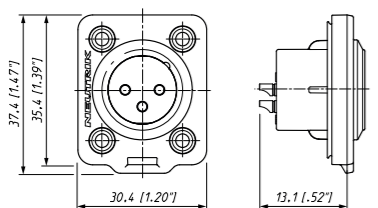

**NC3FD-V / NC3FD-H**

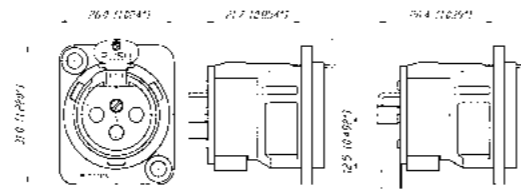

**NC3MD-V / NC3MD-H**

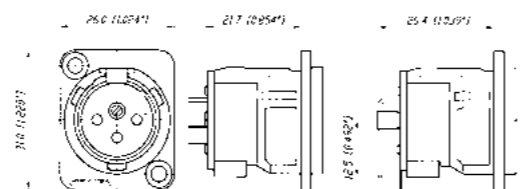

**NC3FD-L-1**

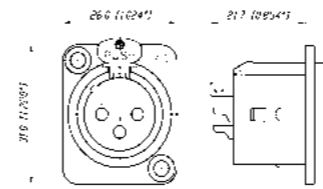

**NC\*FDM3-H**

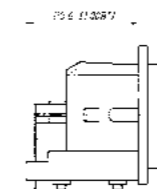

**NC3MD-L-1**

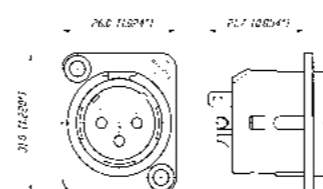

**NC\*MDM3-H**

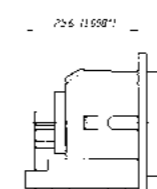

**NC3FD-LX**

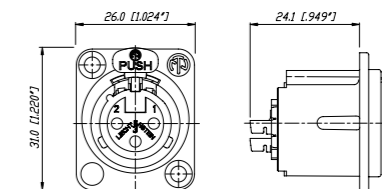

**NC\*MD-LX**

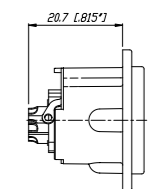

\*: 3 - 5 contacts

\*: 3 - 5 contacts

\*: 3 - 7 contacts



Crimp type contact



Circumferential ground spring

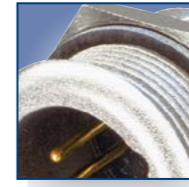

Sealing gasket

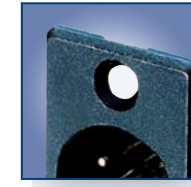

Through hole fastening

**DLX Crimp Series**

**EMC Series**

**MPR-HD Series**

**P Series**



NC3FD-LX-HA



NC3MD-LX-BAG-HA



NC3FDX-EMC-SPEC



NC3MPR-HD



NC5MPR-HD



NC3FP-1



NC6MP-B

- 3 pole DLX Series with crimp contacts
- Accommodates wire size AWG 24 – 22 or 0.22 – 0.34 mm<sup>2</sup>
- Utilizes standard B-type crimp tool (acc. IEC 60352-2)
- Absolute leadfree and solderless connection:
  - RoHs compliance
  - Health and eco-friendly
- Fast and easy assembly
- Gas-tight connection offers a constant contact resistance
- Ideal solution for field and on-site termination

- 3 pole female XLR chassis connector with integrated capacitive shield to shell connection to avoid RF-interference and LF-noise
- 360° shield contact ensures best possible shielding and chassis contact
- D flange chassis for panel mount applications
- Includes the locking nut of the NC3FX-SPEC for secure fastening of a gooseneck for instance
- Special flange for large openings available
- Patent pending

Detailed information of RF-shielding see page 7 – EMC cable connector.

- IP 65 – in combination with NC\*FX-HD cable connectors
- Perfect for outdoor applications
- Sealing gasket for water tight panel mount
- Gold plated contacts

- Male and female available in 3 – 6 pin configurations; 7 pin version available in female only
- Smallest available hard wiring receptacles with large solder cups
- Male and female use different mounting hole dimensions and do not fit in the same mounting hole
- Front mountable only
- One piece version – insert is NOT removable from shell
- Short female receptacle
- Compatible with Switchcraft® DxM, DxF; Cannon XLRx31, XLRx32
- 6 pole female version available with Switchcraft contact arrangement



NC5FX-HD

NC5MPR-HD

NC3FD-LX-HA

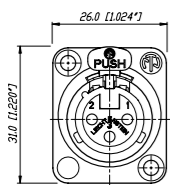

NC3MD-LX-HA

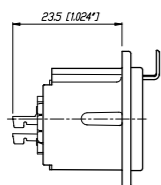

NC3FDX-EMC-SPEC

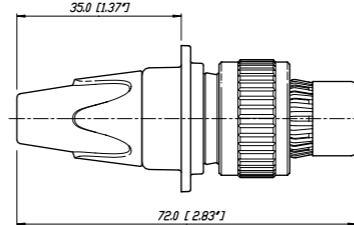
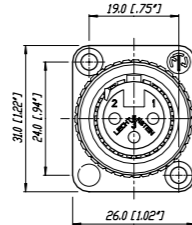

NC3MPR-HD

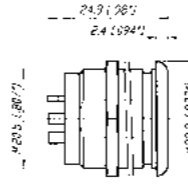
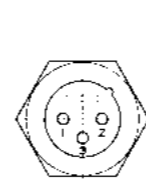

NC3FP-1

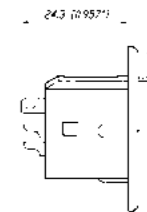
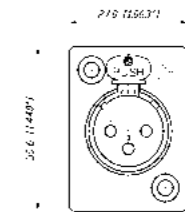

NC3MP

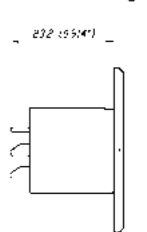
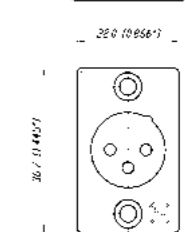

\*: 3 - 5 contacts



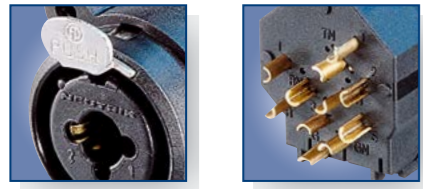

Front end design      Solder termination

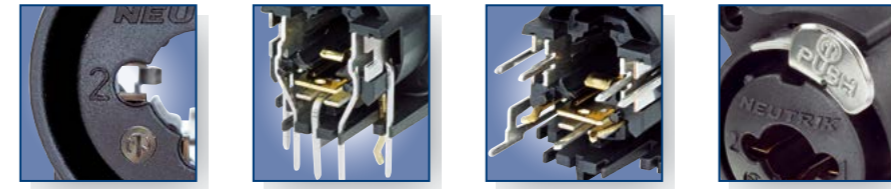

Hologram      Horizontal PCB mount      Vertical PCB mount      **NEW:** Ergonomic asymmetric locking release tab

**Combo I Series**



NCJ9FI-V



NCJ10FI-S

- Combined XLR receptacle and 1/4" phone jack
- Attractive "front end" design
- Saves rack space by combining 2 connectors in one housing
- Horizontal or vertical PCB mount or hard wire soldering
- Fully normalled
- Stereo or mono version

- Very low conductor capacitance, therefore suitable for digital audio
- Fastening: Self-tapping Plastite® screws with thread 2.9 x 1.06 and tri-rondular configuration (A screw)



XLR receptacle or 1/4" phone jack

NCJ10FI-H

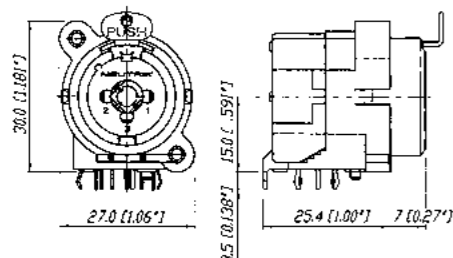

Wiring: Example of NCJ9FI-H



**Combo A Series**



NCJ6FA-V-0



NCJ6FA-H



NCJ6FA-V-0

- Combined 3 pole XLR receptacle and 1/4" phone jack for balanced mic and line or instrument inputs in one XLR housing
- Dramatic space saving – 15 % over the predecessor Combo
- Two connectors in one housing – substantial cost, material and labour saving
- Horizontal and vertical PCB mount available

- 3 pole female XLR combined with stereo TRS jack
- Very low conductor capacitance – ideal for digital audio
- Front panel cut-out compatible with Neutrik XLR A Series
- Branded with unique hologram – guarantees genuine and authentic Neutrik product

NCJ6FA-V

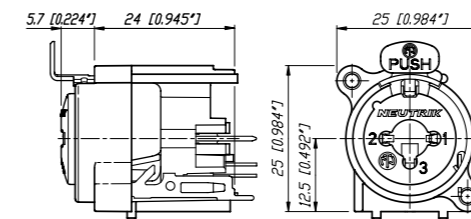

NCJ6FA-H

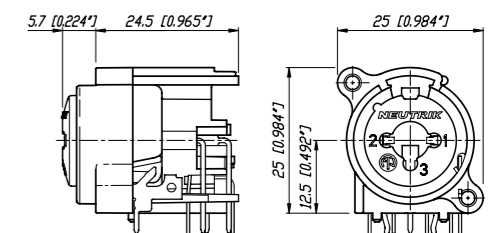

Specification	A Series	AA Series	B Series	XLR TOP Series	D Series	DL / DLX Series	DLX Crimp
---------------	----------	-----------	----------	----------------	----------	-----------------	-----------

Electrical							
Number of contacts	3 - 5	3	3 - 5	3 - 5	3	3 - 7	3
Contact resistance XLR: $\leq 6 \text{ m}\Omega$	●	●	●	●	●	●	●
1/4" & switching contacts**:	-	-	-	-	-	-	-
Insulation resistance - initial: $> 10 \text{ G}\Omega$	●	●	●	●	●	●	●
- after damp heat test: $> 1 \text{ G}\Omega$	●	●	●	●	●	●	●
Dielectric strength 1.5 kV dc	●	●	●	●	●	●	●
Rated voltage $< 50 \text{ V ac}$	●	●	●	●	●	●	●
Rated current per contact							
3 pole: 6 A	●	●	●	16 A	●	16 A	1 A
4 pole: 6 A	●	-	●	-	-	10 A	-
5, 6 pole: 3 A	●	-	●	7.5 A	-	7.5 A	-
7 pole: 5 A	-	-	-	-	-	●	-
Combo XLR + Jack contact 7.5 A	-	-	-	-	-	-	-
Capacitance between contacts							
3 pole: $\leq 4 \text{ pF}$	●	●	●	●	-	●	●
4, 5, 6 pole: $\leq 7 \text{ pF}$	●	-	●	●	-	●	-
7 pole: $\leq 9 \text{ pF}$	-	-	-	-	-	●	-

Mechanical							
Lifetime $> 1'000$ mating cycles	●	●	●	●	●	●	●
Insertion / withdrawal force $\leq 20 \text{ N}$	●	●	●	●	●	●	●
Retention method							
- standard: latch lock	●	●	●	●	●	●	●
- "0" Version: $\geq 20 \text{ N}$ separating force	●	●	●	●	●	●	-
Crimp XX: 0.22 - 0.34 mm <sup>2</sup> / AWG 24 - 22	-	-	-	-	-	-	●

Material							
Insert Polyamide PA 6.6	●	●	●	●	●	●	●
Shell Zinc diecast ZnAl4Cu1	-	-	-	PA 6.6 30% GR	●	●	●
Shell plating gal Ni or black Cr	-	-	●	-	●	●	●
Ring Zinc diecast ZnAl4Cu1	-	-	●	-	-	-	-
Contacts - female 3 pole: Bronze CuSn6	●	●	●	●	●	●	●
4 - 5 pole: Bronze CuSn6	●	-	-	-	-	-	-
4 - 7 pole: Brass CuZn39Pb3	-	-	-	●	-	●	-
- male: Brass CuZn35Pb2	●	●	●	●	●	●	●
Contact surface gal 0.2 $\mu\text{m}$ AuCo over 2 $\mu\text{m}$ NiP15 (Tribor®)	●	●	●	-	-	-	-
gal 2 $\mu\text{m}$ Ag or gal 0.2 $\mu\text{m}$ Au hard alloy over 2 $\mu\text{m}$ Ni	-	-	-	●	●	●	●
Latch lock & spring Ck 67 steel, treated	●	●	●	●	●	●	●

Environmental							
Operating temperature -30 °C to +80 °C	●	●	●	●	●	●	●
Protection class IP 40	●	●	●	IP65 <sup>3)</sup>	●	●	●
Flammability UL 94 HB	-	●	-	●	-	-	-
UL 94 V-0	●	-	●	-	●	●	●
Solderability complies with IEC 68-2-20	●	●	●	●	●	●	●
Mounting screw A	A	A	1)	-	-	-	-
Color coding ACR* <sup>2)</sup>	-	-	ACR* <sup>2)</sup>	-	DSS	DSS	DSS

(4 + 5 pole only)

1) : B Series 3 pole connectors > B-screw, 4 & 5 pole versions > A-screw  
 2) : 4 + 5 pole A series, 5 pole B series  
 3) : UL50E (mated)

Specification	DLX-HE Series	MPR-HD Series	P Series	Combo I Series	A Combo
---------------	---------------	---------------	----------	----------------	---------

Electrical					
Number of contacts	3	3-5	3-7(6*)	5-10	3/3
Contact resistance XLR: $\leq 6 \text{ m}\Omega$	●	●	●	$\leq 10 \text{ m}\Omega$	$\leq 10 \text{ m}\Omega$
1/4" & switching contacts**:	-	-	-	●	$\leq 10 \text{ m}\Omega$
Insulation resistance - initial: $> 10 \text{ G}\Omega$	●	●	●	●	●
- after damp heat test: $> 1 \text{ G}\Omega$	●	●	●	$> 500 \text{ m}\Omega$	●
Dielectric strength 1.5 kV dc	●	●	●	●	●
Rated voltage 50 V ac	●	●	●	●	●
Rated current per contact					
3 pole: 6 A	16 A	16 A	16 A	-	3 A
4 pole: 6 A	-	10 A	10 A	-	-
5, 6 pole: 3 A	-	7.5 A	7.5 A	-	-
7 pole: 5 A	-	-	●	-	-
Combo XLR + Jack contact 7.5 A	-	-	-	●	●
Capacitance between contacts					
3 pole: $\leq 7 \text{ pF}$	$\leq 4 \text{ pF}$	$\leq 4 \text{ pF}$	$\leq 4 \text{ pF}$	$\leq 2 \text{ pF}$	$\leq 2 \text{ pF}$
4, 5, 6 pole: $\leq 7 \text{ pF}$	-	●	●	-	-
7 pole: $\leq 9 \text{ pF}$	-	-	●	-	-

Mechanical					
Lifetime $> 1'000$ mating cycles	●	●	●	●	●
Insertion / withdrawal force $\leq 20 \text{ N}$	●	●	●	25 N	●
Retention method					
- standard: latch lock	●	●	●	●(XLR)	●(XLR)
- "0" Version: $\geq 20 \text{ N}$ separating force	-	●	●	25 N	25 N
Crimp XX: 0.22 - 0.34 mm <sup>2</sup> / AWG 24 - 22	-	-	-	-	-

Material					
Insert Polyamide PA 6.6	PSS 40% GR	●	●	●	●
Shell Zinc diecast ZnAl4Cu1	●	●	●	-	-
Shell plating gal Ni or black Cr	velour Cr	Ni	●	-	-
Ring Zinc diecast ZnAl4Cu1	-	-	-	-	-
Contacts - female 3 pole: Bronze CuSn6	●	-	●	●	●
4 - 5 pole: Bronze CuSn6	-	-	-	-	-
4 - 7 pole: Brass CuZn39Pb3	-	-	●	-	-
- male: Brass CuZn35Pb2	●	●	●	-	-
Contact surface gal 0.2 $\mu\text{m}$ AuCo over 2 $\mu\text{m}$ NiP15 (Tribor®)	●	-	-	●	●
gal 2 $\mu\text{m}$ Ag or gal 0.2 $\mu\text{m}$ Au hard alloy over 2 $\mu\text{m}$ Ni	-	Au	●	-	-
Latch lock & spring Ck 67 steel, treated	●	-	●	●	●

Environmental					
Operating temperature -30 °C to +80 °C	●	●	●	●	●
Protection class IP 40	●	IP 65	●	●	●
Flammability UL 94 HB	-	●	-	-	-
UL 94 V-0	●	-	●	●	●
Solderability complies with IEC 68-2-20	●	●	●	●	●
Mounting screw -	-	-	-	A	A
Color coding DSS	-	-	-	-	-

\*... P Series male 3 - 6 pole  
 \*\*... if existing





## Ordering Information for Receptacles

Female	Male	Shell	Contact	3	4	5	6	7	Shell	Contact	5	6	9	10
				pole	pole	pole	pole	pole			pole	pole	pole	pole

### EMC XLR

NC3FDX-EMC-SPEC	Black Cr	Gold	●	-	-	-	-	-
-----------------	----------	------	---	---	---	---	---	---

### Accessories

FDR-1	Black round panel mounting flange with screws for larger panel cut-outs
-------	---

### P Series

NC*FP-1		Nickel	Silver	●	●	●	●	●
	NC*MP	Nickel	Silver	●	●	●	●	-
NC*FP-B-1		Black Cr	Gold	●	●	●	●	●
	NC*MP-B	Black Cr	Gold	●	●	●	●	-
NC*FP-BAG-1	NC*MP-BAG	Black Cr	Silver	●	●	●	●	-

### MPR-HD Series

-	NC*MPR-HD	Nickel	Gold	●	●	●	-	-
---	-----------	--------	------	---	---	---	---	---

### Combo A Series

NCJ6FA-H	Black plastic	Gold	-	●	-	-
NCJ6FA-H-0	Black plastic	Gold	-	●	-	-
NCJ6FA-H-DA	Black plastic	Gold	-	●	-	-
NCJ6FA-V	Black plastic	Gold	-	●	-	-
NCJ6FA-V-0	Black plastic	Gold	-	●	-	-
NCJ6FA-V-DA	Black plastic	Gold	-	●	-	-

### Combo I Series

NCJ*FI-H	Black plastic	Gold	●	●	●	●
NCJ*FI-H-0	Black plastic	Gold	●	●	●	●
NCJ*FI-S	Black plastic	Gold	●	●	●	●
NCJ*FI-S-0	Black plastic	Gold	●	●	●	●
NCJ*FI-V	Black plastic	Gold	●	●	●	●
NCJ*FI-V-0	Black plastic	Gold	●	●	●	●

### Contact #

	1	2	3	T	R	S	TN	RN	SN	G	GN
NCJ5FI-*	x	x	x	x		x					x
NCJ6FI-*	x	x	x	x	x	x					x
NCJ9FI-*	x	x	x	x	x	x	x	x	x	x	x
NCJ10FI-*	x	x	x	x	x	x	x	x	x	x	x

## Panel Cutouts

A/AA/B Series

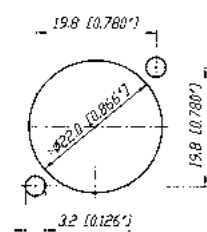

D/DL/DLX Series

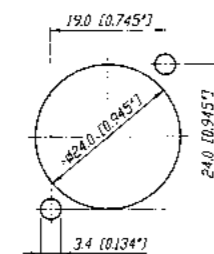

P Series Female

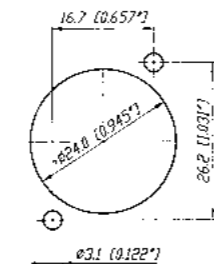

P Series Male

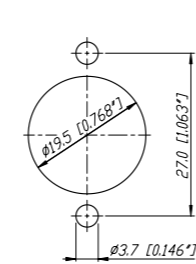

Combo

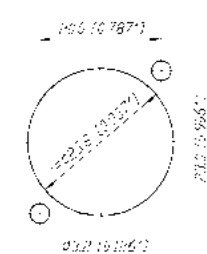

MPR Series

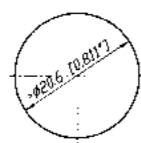

## Color Coded Accessories

Part No.	Description	Black	Brown	Red	Orange	Yellow	Green	Blue	Violet	Grey	White
		0	1	2	3	4	5	6	7	8	9
ACRF-*	Colored ring for female 4 pole A Series and 4 + 5 pole B Series										
ACRM-*	Colored ring for male 4 pole A Series and 4 + 5 pole B Series										
DSS-*	Lettering plate for D Series										

## Accessories

A-Screw-1-8	Plastite® screw 2.9 x 8
B-Screw-1-8	TAPTITE® screw 2.5 x 8
DBA	Dummy-plate for D Series panel cut outs
FDR1	Round panel mounting flange for NC3FDX-EMC-SPEC
HA-3FXX	Set of 50 female spare contacts for crimp XLR
HA-3MXX	Set of 50 male spare contacts for crimp XLR
MFD	M3 mounting frame for D-size chassis
NDF	dummyPLUG for female XLR chassis connector
NDM	dummyPLUG for male XLR chassis connector
SCF	Rubber sealing cap for female XLR receptacles
SCM	Rubber sealing cap for male XLR receptacles
SCFDX-TOP	Sealing cover for NC*FDX-TOP
SCMDX-TOP	Sealing cover for NC*MDX-TOP
PUSH-ASYM	Asymmetric push for A/AA/B & Combo A Series
NZP1RU-8	Panel 1RU with 8 D-shape housing cutouts
NZP1RU-12	Panel 1RU with 12 D-shape housing cutouts
SCDR	Rear end protection cover for D size chassis connectors
SCDX	Hinged cover seals D-size chassis connectors, IP42 rated
SCCD-W	Spring-loaded cover to seals D size chassis connectors, IP65 rated
SCDP-*	D Size sealing gaskets, color coding
SFAV	Rubber frame for A / B Series to mount between front plate and rear vertical print





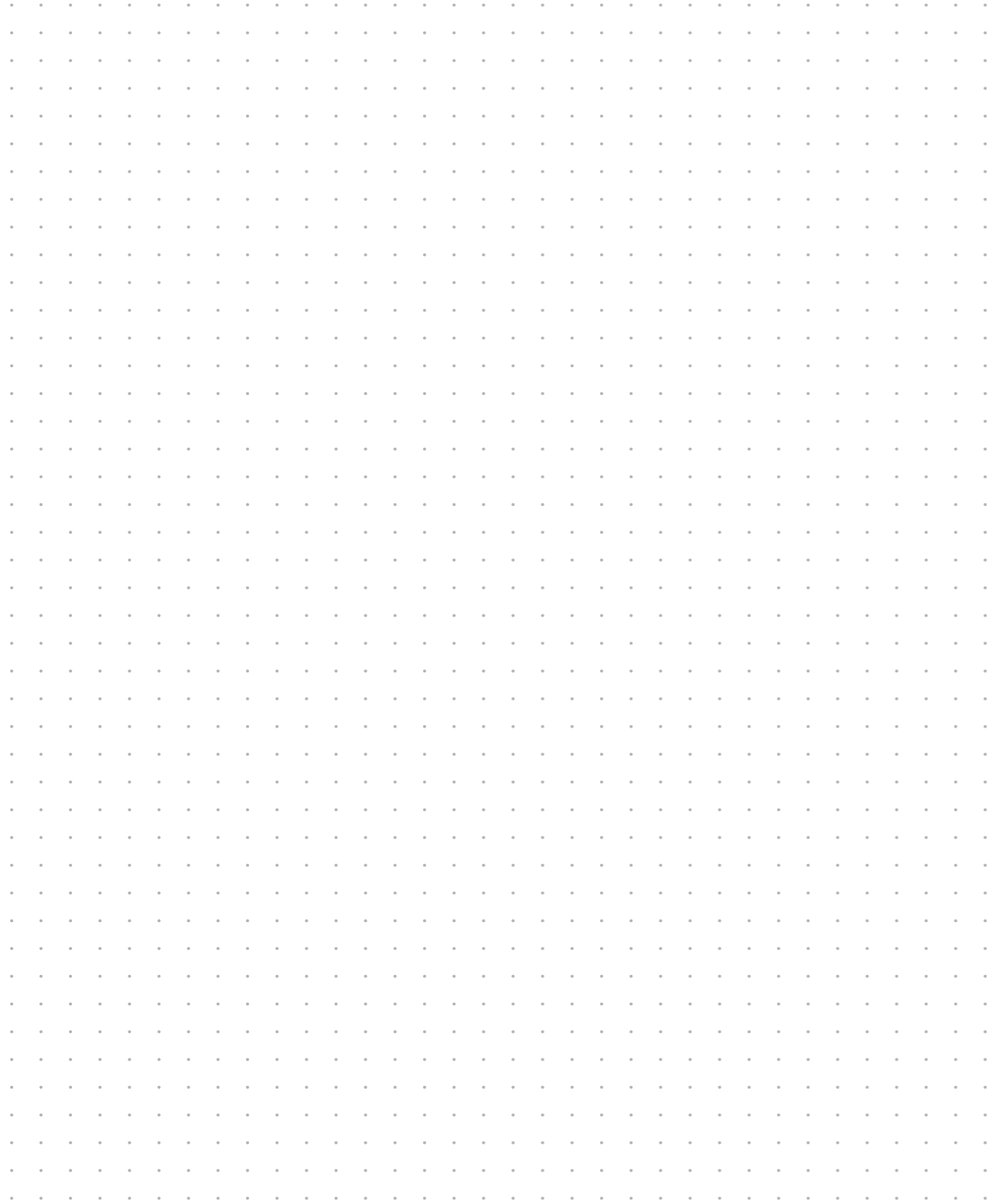

**Definitions, Abbreviations & Useful Information**

**ELEMENTS**

<b>Ag</b>	Silver
<b>Al</b>	Aluminium
<b>Au</b>	Gold
<b>Co</b>	Cobalt
<b>Cr</b>	Chromium
<b>Cu</b>	Copper
<b>Ni</b>	Nickel
<b>P</b>	Phosphorus
<b>Pb</b>	Lead
<b>Pd</b>	Palladium
<b>Sn</b>	Tin
<b>Zn</b>	Zinc
<b>SS</b>	Stainless Steel

**ALLOYS, PLASTICS, POLYMERS**

<b>Brass (Alloy)</b>	CuZn39Pb3
<b>Bronze (Alloy)</b>	CuSn6
<b>Ck 67</b>	Carbon Steel
<b>EPDM</b>	Ethylene Propylene
<b>GR</b>	Glass Reinforced
<b>PA</b>	Polyamide
<b>PBTP</b>	Polybutylene Terephthalate
<b>POM</b>	Polyacetal
<b>PTFE</b>	PolyTetraFluoroEthylene (TEFLON)
<b>PUR</b>	Polyurethane

**MEASUREMENT LEGEND**

<b>N</b>	Newton
<b>Ω</b>	Ohm
<b>μ</b>	Micro
<b>OD</b>	Outside Diameter
<b>m</b>	Meter(s)
<b>k</b>	Kilo

**ENGLISH TO METRIC CONVERSIONS**



<b>1/8 inch</b>	3.175	millimeters (mm)
<b>1/4 inch</b>	6.35	millimeters (mm)
<b>1 inch</b>	25.4	millimeters (mm)
	2.54 cm	1 inch
<b>1 foot</b>	30.48	centimeters (cm)
	0.305	meter (m)
<b>6 foot</b>	1.828	meters (m)
<b>50 foot</b>	15.24	meters (m)
<b>100 foot</b>	30.48	meters (m)
<b>1000 foot</b>	304.8	meters (m)

**METRIC TO ENGLISH CONVERSIONS**

<b>1 centimeter</b>	0.3937	inches
<b>1 meter</b>	39.37	inches
<b>3.281 meter</b>	10	feet
<b>10 meters</b>	32.808	feet
<b>50 meters</b>	164.041	feet
<b>100 meters</b>	328.084	feet

**OTHER ABBREVIATIONS**

<b>UL®</b>	Underwriters Laboratories
<b>IP Rating</b>	Ingress Protection rating for objects and water ACC IEC529/EN60529
<b>IEC</b>	International Electrotechnical Commission is the international standards and conformity assessment body for all fields of electrotechnology
	UL Recognized Component Mark

	<b>ENEC</b> – European norms electrical certification, demonstrates compliance with European safety standards.
	<b>VDE</b> Association for Electrical, Electronic and Information Technologies e.V.
<b>AWG</b>	American Wire Gauge

NEUTRIK, crystalCON®, etherCON®, maxCON®, miniCON®, nanoCON®, neutriCON®, opticalCON®, powerCON®, powerCON® TRUE1, Profi®, rearTWIST®, silentPLUG®, speakON®, TOP®, DiWA®, XIRIUM®, are registered trademarks of Neutrik AG.



# NEUTRIK®

The premium brand of the Neutrik Group

## LIECHTENSTEIN (HEADQUARTERS)

Neutrik AG, Im alten Riet 143, 9494 Schaan  
T +423 237 24 24, F +423 232 53 93, neutrik@neutrik.com

## GERMANY / NETHERLANDS / DENMARK / AUSTRIA

Neutrik Vertriebs GmbH, Felix-Wankel-Straße 1, 85221 Dachau, Germany  
T +49 8131 28 08 90, neutrik@neutrik.de

## GREAT BRITAIN

Neutrik (UK) Ltd., Westridge Business Park, Cothey Way  
Ryde, Isle of Wight PO33 1 QT  
T +44 1983 811 441, sales@neutrik.co.uk

## FRANCE

Neutrik France SARL, 52 rue d'aguesseau, 1er etage, 92100 Boulogne-Billancourt  
T +33 1 41 31 67 50, info@neutrik.fr

## USA

Neutrik USA Inc., 4115 Taggart Creek Road, Charlotte, North Carolina, 28208  
T +1 704 972 3050, info@neutrikusa.com

## JAPAN

Neutrik Limited, Yusen-Higashinonbashi-Ekimae Bldg., 3-7-19  
Higashinonbashi, Chuo-ku, Tokyo 103  
T +81 3 3663 47 33, mail@neutrik.co.jp

## HONG KONG

Neutrik Hong Kong Ltd., Suite 18, 7th Floor Shatin Galleria  
Fotan, Shatin  
T +852 2687 6055, sales@neutrik.com.hk

## CHINA

Ningbo Neutrik Trading Co., Ltd., Shiqi Street, Yinxian Road West  
Fengjia Villiage, Hai Shu Area, Ningbo, Zhejiang, 315153  
T +86 574 88250833, sales@neutrik.com.cn

## ASSOCIATED COMPANIES

### Contrik AG

Steinackerstrasse 35, 8902 Urdorf, Switzerland  
T +41 44 736 50 10, contrik@contrik.ch

### H. Adam GmbH

Felix-Wankel-Straße 1, 85221 Dachau, Germany  
T +49 08131 28 08-0, anfrage@adam-gmbh.de

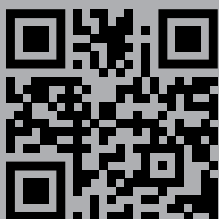

[www.neutrik.com](http://www.neutrik.com)